



www.kings-group.net

248 Hoe Street
Walthamstow E17 3AX
Tel: 020 8521 1122

Banbury Road, London, E17 5SZ
£2,200 Per Month

Kings Lettings are proud to present this three bedroom mid terrace property. The property consists of a kitchen/diner, a large lounge and a W/C all on the ground floor. The first floor consists of three double bedrooms as well as a family shower room. The property comes with fully double glazed windows and gas central heating. The property also has the added benefits of front and rear gardens as well as a drive way to the front. The property is located with direct access to the north circular as well as being within walking distance to Black Horse Road station. Lea Valley is also easily accessible so country walks; bridle paths and cycling tracks are all on your doorstep. Call today and do not miss your opportunity to view this fantastic property.



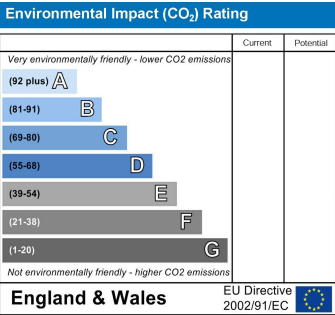
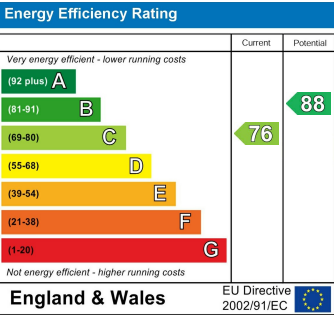





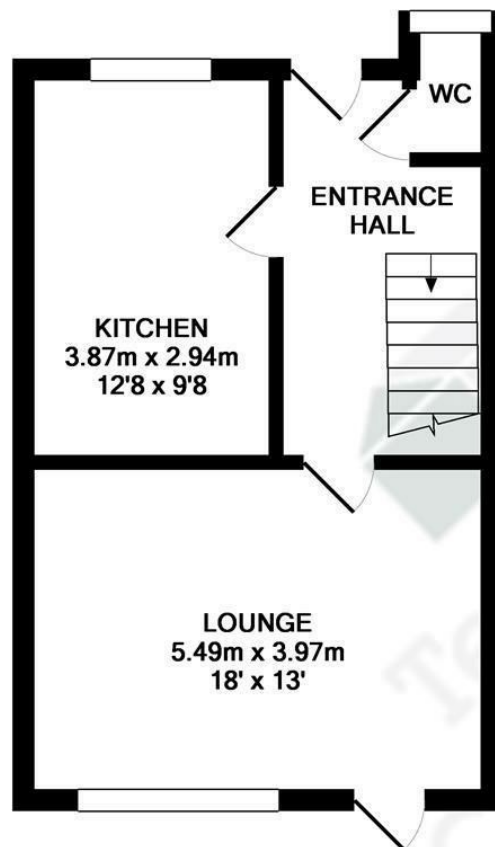

GROUND FLOOR
APPROX. FLOOR
AREA 34.4 SQ.M.
(371 SQ.FT.)

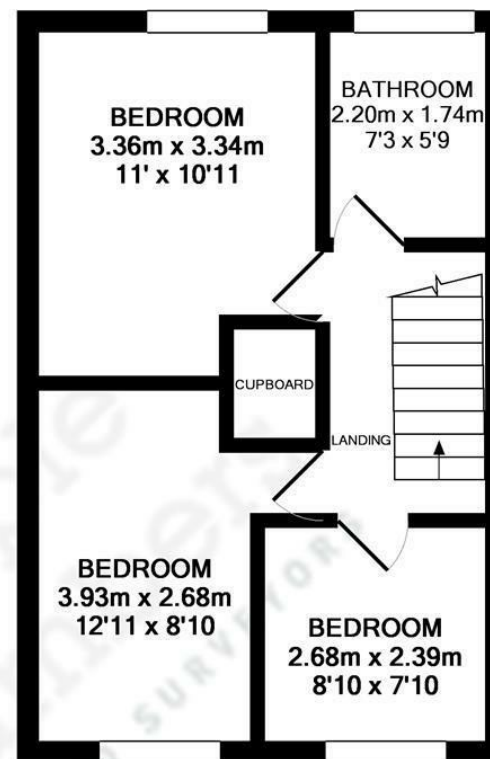

1ST FLOOR
APPROX. FLOOR
AREA 34.0 SQ.M.
(366 SQ.FT.)

TOTAL APPROX. FLOOR AREA 68.5 SQ.M. (737 SQ.FT.)

Whilst every attempt has been made to ensure the accuracy of the floor plan contained here, measurements of doors, windows, rooms and any other items are approximate and no responsibility is taken for any error, omission, or mis-statement. This plan is for illustrative purposes only and should be used as such by any prospective purchaser. The services, systems and appliances shown have not been tested and no guarantee as to their operability or efficiency can be given

Made with Metropix ©2018

